

PROSPETTO FRONTALE - LEDWALL CHIUSO

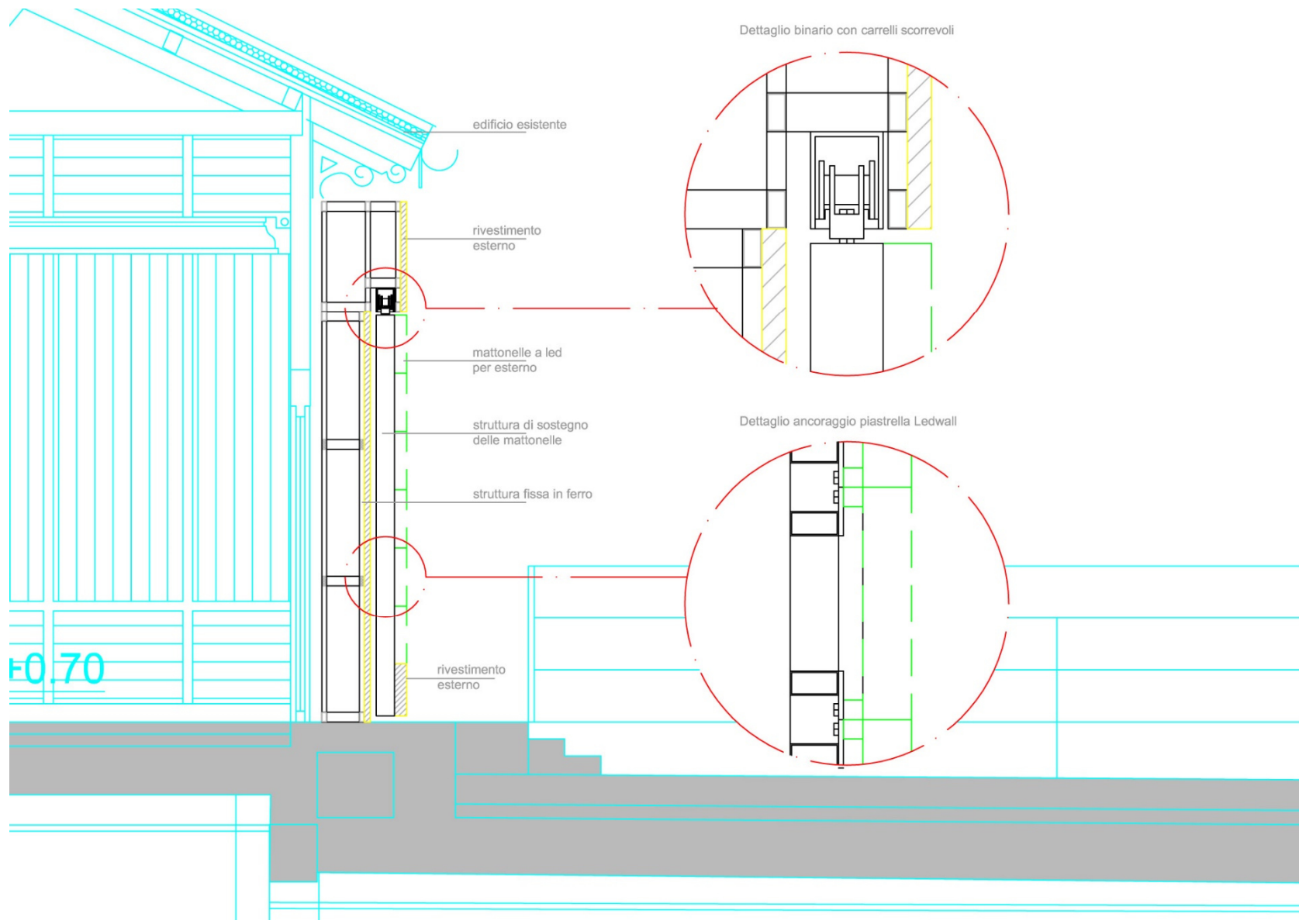

# SMD Outdoor Die-casting Ultra Slim Cabinet

for P6.66, P8, P10, P13.33

**SMD Outdoor Die-casting  
Ultra Slim Cabinet**

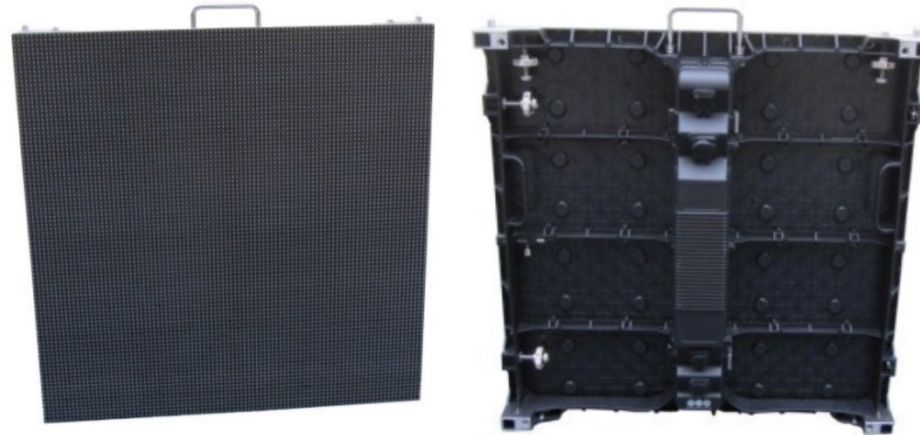

**Light weight and slim design, low power consumption and wide viewing angle.**

- 12.5kgs /cabinet (include power supply and receiving card)
- Cabinet size: 640mm(w)\*640mm(h)=0.4096m<sup>2</sup>
- Module size: 320mm(w)\*160mm(h)

**Models: SMD  
P6.67,P8,P10,P13.3(available)**

Brightness:>5000cd/m<sup>2</sup>

IP grade: IP65

Viewing angle:140°



**Fast Lock,  
can load  
800kgs**

**Location pin  
in side**

**The top location pins are  
removable**

**Smart Signal, Power & Test Indicator**

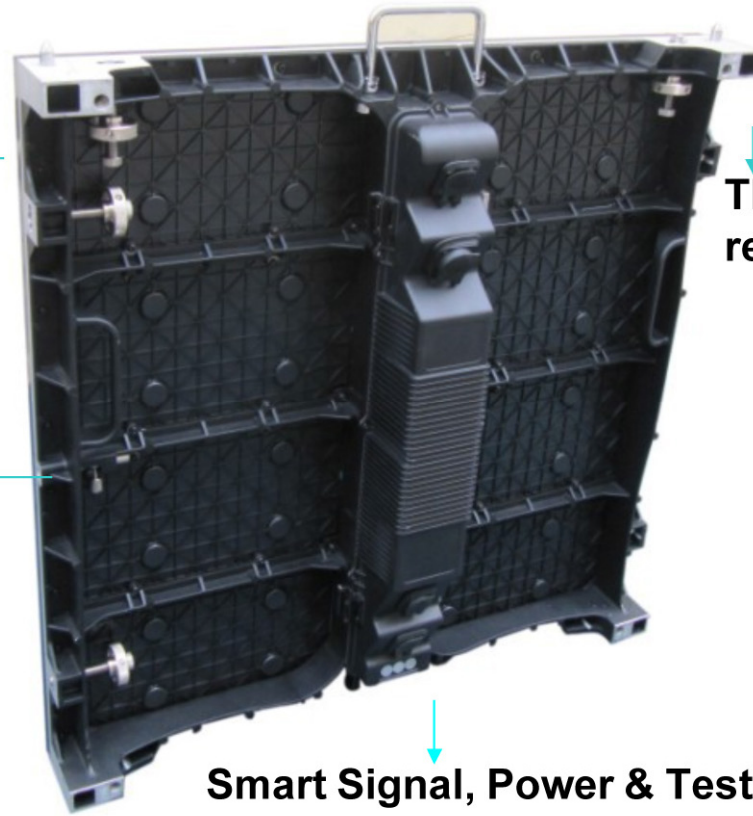



## The main features:

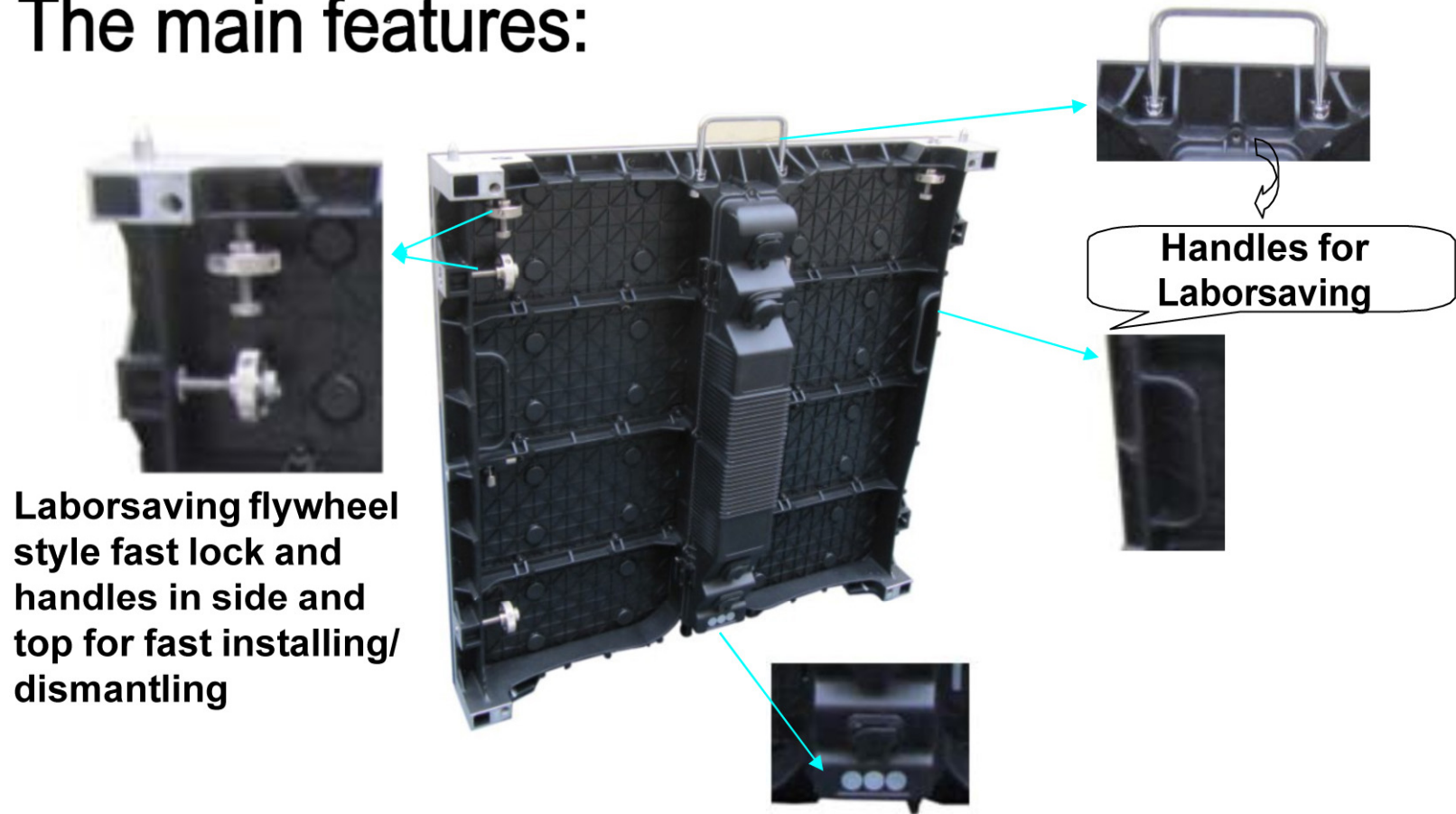

**Smart Signal, power, and test indicator to tell you the problems when instal in the first time.**

## Specification of P6.66

Pixel pitch	6.66mm	Color temperature	6500k
Size of cabinet	640mm*640mm	Control method	Synchronization
Resolution of cabinet	96*96	Driving device	Constant current
Weight of cabinet	<12.5KG	Driving method	1/ 8 scanning
Size of module	230mm*160mm	Frame frequency	60Hz
Resolution of module	48*24	Refresh frequency	1000HZ
Density	22500dots/M2	Brightness	>5000cd/M2
Best viewing distance	>6M	Working voltage	AC220v/110v±10%
Best viewing angle	140 °	Working temperature	-20 ~50 ±10%
Max power consumption	<650W /m²	I P grade	IP65
Colors	16777216	MTBF	10,000 hours
Gray scale	14bits	Life span	100,000 hours



## Specification of P8

Pixel pitch	8mm	Color temperature	6500k
Size of cabinet	640mm*640mm	Control method	Synchronization
Resolution of cabinet	80*80	Driving device	Constant current
Weight of cabinet	<12.8KG	Driving method	1/ 5scanning
Size of module	320mm*160mm	Frame frequency	60Hz
Resolution of module	40*20	Refresh frequency	>1000HZ
Density	15625dot/M2	Brightness	>5000cd/M2
Best viewing distance	>8M	Working voltage	AC220v/110v10%
Best viewing angle	140 degree	Working temperature	-20 -50 ±10%
Max power consumption	< 650W /m <sup>2</sup>	I P grade	IP65
Colors	16777216	MTBF	10000hours
Gray scale	14bits	Life span	100000hours

## Specification of P10

Pixel pitch	10mm	Color temperature	6500k
Size of cabinet	640mm*640mm	Control method	Synchronization
Resolution of cabinet	64*64	Driving device	Constant current
Weight of cabinet	<12.5KG	Driving method	1/ 4 scanning
Size of module	320mm*160mm	Frame frequency	60Hz
Resolution of module	32*16	Refresh frequency	1000HZ
Density	1000dots/M2	Brightness	>5000cd/M2
Best viewing distance	>10M	Working voltage	AC220v/110v±10%
Best viewing angle	140 °	Working temperature	-20 ~50 ±10%
Max power consumption	<650W /m²	I P grade	IP65
Colors	16777216	MTBF	10,000 hours
Gray scale	14bits	Life span	100,000 hours

### Specification of P13.3

Pixel pitch	13.3mm	Color temperature	6500k
Size of cabinet	640mm*640mm	Control method	Synchronization
Resolution of cabinet	48*48	Driving device	Constant current
Weight of cabinet	<12.5KG	Driving method	1/ 2 scanning
Size of module	230mm*160mm	Frame frequency	60Hz
Resolution of module	24*12	Refresh frequency	1000HZ
Density	5625dots/M2	Brightness	>5000cd/M2
Best viewing distance	>13M	Working voltage	AC220v/110v±10%
Best viewing angle	140 °	Working temperature	-20 ~50 ±10%
Max power consumption	<650W /m²	I P grade	IP65
Colors	16777216	MTBF	10,000 hours
Gray scale	14bits	Life span	100,000 hours